

APL3000B Industrial "Node" PC



Available with WinGP



8 GB Bootable CompactFlash® Card



16-128GB Solid State Drive

Node Personal Computer

APL3000B

CPU: Intel® Celeron® M 1.86GHz or Intel® Core™ Duo 2.0GHz

DC 24V

AC100/240V

Windows XP Factory Alert

SSD CF Card

RAID WinGP





Features:

- Industrial "node" PC
- Intel® Core™ Duo 2.0GHz or Intel® Celeron® M 1.86GHz CPU
- 250 GB Hard Drive, Solid State Drive or bootable Compact Flash
- DVD-RW standard
- Reliability, Availability, Serviceability (RAS) Remote Health Monitor
- Data protection – RAID1 hard disk option
- SSD (Solid State Drive) for Reliability and

faster data access

- RoHS directive-conforming
- UL 1604, Class I, Div 2, Groups A, B, C, D

Open HMI WinGP Option

- Use PC as on-demand touch-screen HMI
- Allows third-party applications to run concurrently
 - SPC, vision, SCADA, MRP
- Expands PC hardware and data connectivity options

Performance Specifications

	Performance	Standard
Base Model	APL3000-BA-CD2G APL3000-BD-CD2G	APL3000-BA-CM18 APL3000-BD-CM18
CPU	Intel® Core™ Duo 2.0GHz	Intel® Celeron® M 1.8GHz
Supported OS	Windows® XP Pro / XP ML	Windows® XP Pro / XP ML
Standard Memory	1GB/ 2GB/ 4GB	
Maximum Memory	4GB (DIMM socket x 2)	
Graphics Display Resolution	VGA (640 x 480 pixels) to UXGA (1600 x 1200 pixels)	
Video Memory	Max 64MB (UMA type)	
Serial (RS-232C)	COM1: RS-232C, D-sub 9 pin (plug) (RI/+5V switchable, RS-422/RS-485 switchable) COM2: RS-232C, D-sub 9 pin (plug) (RI/+5V switchable) COM3: RS-232C, D-sub 9 pin (plug) COM4: RS-232C, D-sub 9 pin (plug)	
LAN	2 ports. RJ-45 type modular jack connector (8 pins). LAN1: auto change to 10BASE-T/100BASE-TX/1000BASE-T LAN2: auto change to 10BASE-T/100BASE-TX	
USB	USB 2.0 compatible 4 ports. Disable/enable selectable.	
Sound	Speaker out (3.5mm mini-pin jack connector)	
RAS (Remote Health Monitor)	RAS connector 9-pin (socket)	
Disk	250 GB hard disk drive, 80-160 GB Solid State Drive. SATA interface. IDE interface: Master: 8 GB CF card I/F. Slave: DVD-RW 1 slot	
PCI	PCI x 2 or PCI x 4; first 2 slots are: 174.63 [6.88 in.] x 106.68 [4.20 in.] mm; Slots 3 and 4 are: 250 [9.84 in.] x 106.68 [4.20 in.] mm	

General Specifications

Input Voltage	AC100 / 240V (Rated voltage AC85 to 264V; 50/60Hz)	DC24V (Rated voltage DC19.2 to 28.8V)
Power Consumption	2-slot: 120VA or less 4-slot: 145VA or less	2-slot: 120W or less 4-slot: 145W or less
Allowable Voltage Drop	1 cycle or less (Voltage drop interval must be 1s or more.)	5ms or less
Voltage Endurance	AC1500V 20mA for 1 minute (between charging and FG terminals)	AC1000V 20mA for 1 minute (between charging and FG terminals)
Insulation Resistance	DC500V 10MΩ(min.) (between charging and FG terminals)	
Certifications	UL 508; CSA-C22.2 No. 142-M1987; CE Marking EN61000-6-2, EN55011 Class A, EN60950-1 (Only AC model), UL 1604, Class I, Div 2, Groups A, B, C, D	
Temperature	0 to 50°C (32 to 122°F) without HDD; 5 to 50°C (41 to 122°F) with HDD; Storage Temperature: -20 to +60°C (-4 to 140°F)	
Humidity - Ambient/Storage	10 to 90% RH (Not condensing, wet bulb temperature: 39°C (122°F) or less; with HDD: 29°C (84.2°F) or less).	
Corrosive Gas	Free of corrosive gases	
Noise Immunity	Noise Voltage: 1500Vp-p, Pulse Duration: 50ns, 500ns, 1 μs Rise Time: 1ns	Noise Voltage: 1000Vp-p, Pulse Duration: 1μs Rise Time: 1ns (via noise simulator)
Cooling Method	Forced air cooling by system fan and CPU fan	
Electrostatic Discharge Immunity	6kV (complies with EN 61000-4-2 Level 3)	
Vibration Resistance	IEC61131-2 compliant, With HDD: 10 to 57Hz half-amplitude 0.075mm, 57 to 150Hz constant-accelerated velocity 9.8m/s ² . X, Y, Z directions for 10 cycle (100 minute) Without HDD: 5 to 9Hz half-amplitude 3.5mm, 9 to 150Hz constant-accelerated velocity 9.8m/s ² . X, Y, Z directions for 10 cycle (100 minute)	
Shock during operation	147m/Sec, 11msec (Approx. 15G), 3 shocks to 3 direction/ axis, in accordance with EN/IEC 60068-2-27	
Weight With DVD-RW	2-slot: 7.45kg [16.4lb] max. 4-slot: 8.95kg [19.7lb] max.	
External Dimensions With DVD-RW	2-slot: W243mm [9.57in.] x H163mm [6.42in.] x D277mm [10.91in.] 4-slot: W243mm [9.57in.] x H214mm [8.42in.] x D277mm [10.91in.]	
Warranty	Two-year standard (Maximum 4 years)	

APL3000B - External Dimensions

Dimensions shown with installation fasteners attached

APL3000B (2-slot)

Unit: mm [in]

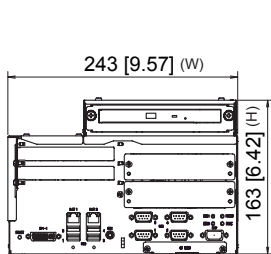

Front

APL3000B (4-slot)

Unit: mm [in]

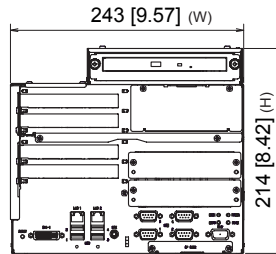

Front

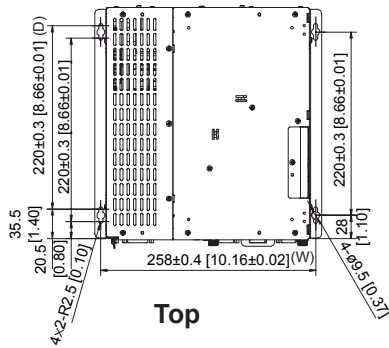

Top

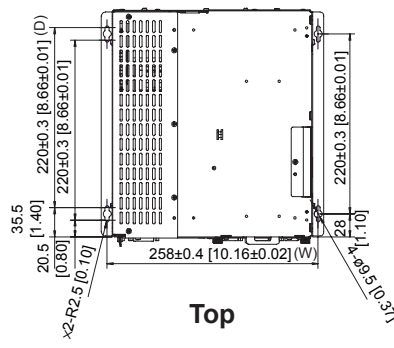

Top

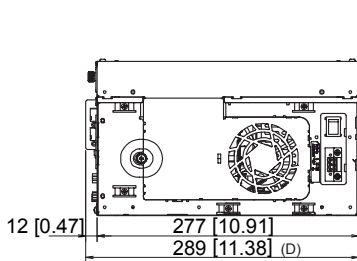

Side

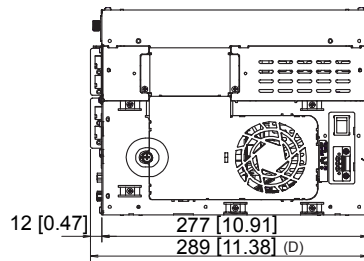

Side

Optional Items

Product Name	Part Number	
DIMM Memory Module	512 MB	CA7-DDR2-512MB
	1 GB	CA7-DDR2-1GB
	2 GB	CA7-DDR2-2GB
HDD Unit *1	250 GB	APL3000-HD250
CF Card*1	512MB	CA3-CFCALL/512MB-01
	1GB	CA6-CFCALL/1GB-01
	2GB	CA8-CFCALL/2GB-01
	8GB	144766
RAID Kit	RAID-KIT-01	
USB Front Cable	1m	CA5-USBEXT-01
USB Cable	5m	FP-US00
RS-232C Cable	5m	FP61V-IS00-0
DVI-D Cable	5m	FP-DV01-50
Analog RGB Cable *2	4.5m	FP-CV02-45
RGB Converter Cable	5m	CA7-CBLCVRGB-01
DVI-D/RGB Branch Cable	15cm	CA7-CBLCVDVI-D/RGB-01
Installation Fastener	APL-ATFB-01	
External Floppy	9000-USBF	

*1 Not installed with operating system. *2 When using the DVI-D/RGB branch cable.

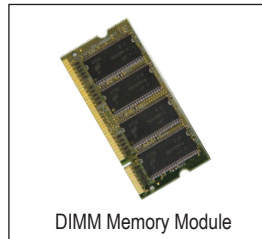
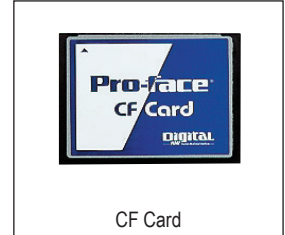

Caution: Before operating any of these products, please be sure to read all related manuals thoroughly.

- All product names used in this document are trademarks or registered trademarks of their respective companies.
- All information contained in this document is subject to change without notice.

Ordering Information

APL3000-B - - - - -M- - - - -

Power supply	_____
A..... AC 100-240V	
D..... DC 24V	
CPU	_____
CM18..... CeleronM440 1.86GHz	
CD2G..... CoreDuo 2.0GHz	
Expansion slots	_____
2P..... PCI x 2 slots	
4P..... PCI x 4 slots	
Memory (DRAM)	_____
1G..... 1GB	
2G..... 2GB	
4G..... 4GB	
Operating System	_____
(RAID and secondary Storage option is not supported with SSD option)	
XM250..... 250GB HDD w/XP ML	
XPC08..... 8GB CF w/XP Pro*	
XMSSDSA..... 80GB SSD w/XP ML	
XMHSDSA..... 160GB SSD w/XP ML	
Secondary Storage	_____
Blank..... No Secondary Storage	
NO250..... 250GB HDD	
NOSSDSA..... 80GB SSD	
NOHSDSA..... 160GB SSD	
RAID	_____
Blank.. No RAID options	
R..... RAID (Include utilities software and additional 250GB HDD)	
Open HMI (WinGP)	_____
Blank..... No Open HMI software included	
WG..... WinGP installed (PC Runtime HMI software, GP-Pro EX)	

*The languages included with this version of Windows XP Pro are English, French, Spanish, Brazilian Portuguese, Japanese, Simplified and Traditional Chinese.

Pro-face America
Phone: 734.477.0060
Fax: 734.864.7347
www.profaceamerica.com

Customer Service Hotline: 800.289.9266

For more information

ACCESS www.profaceamerica.com





California Proposition 65 Warning—Lead and Lead Compounds

Advertencia de la Proposición 65 de California—Plomo y compuestos de plomo

Avertissement concernant la Proposition 65 de Californie—Plomb et composés de plomb

⚠ WARNING: This product can expose you to chemicals including lead and lead compounds, which are known to the State of California to cause cancer and birth defects or other reproductive harm. For more information go to: www.P65Warnings.ca.gov.

⚠ ADVERTENCIA: Este producto puede exponerle a químicos incluyendo plomo y compuestos de plomo, que es (son) conocido(s) por el Estado de California como causante(s) de cáncer y defectos de nacimiento u otros daños reproductivos. Para mayor información, visite : www.P65Warnings.ca.gov.

⚠ AVERTISSEMENT: Ce produit peut vous exposer à des agents chimiques, y compris plomb et composés de plomb, identifiés par l'État de Californie comme pouvant causer le cancer et des malformations congénitales ou autres troubles de l'appareil reproducteur. Pour de plus amples informations, prière de consulter: www.P65Warnings.ca.gov.

All trademarks are the property of Schneider Electric SE, its subsidiaries, and affiliated companies.

Schneider Electric USA, Inc.
800 Federal Street
Andover, MA 01810 USA
888-778-2733
www.schneider-electric.us

Todas las marcas comerciales son propiedad de Schneider Electric SE, sus filiales y compañías afiliadas.

Importado en México por:
Schneider Electric México, S.A. de C.V.
Av. Ejercito Nacional No. 904
Col. Palmas, Polanco 11560 México, D.F.
55-5804-5000
www.schneider-electric.com.mx

Toutes les marques commerciales sont la propriété de Schneider Electric SE, ses filiales et compagnies affiliées.

Schneider Electric Canada, Inc.
5985 McLaughlin Road
Mississauga, ON L5R 1B8 Canada
800-565-6699
www.schneider-electric.ca