

# SP-5B90 eXtreme Box Module

**SP5000X SERIES**



**Features:**

- Enhanced maintenance process.
- Modular design
- Class 1 Div 2, Groups A, B, C, and D
- Combine with any SP-5000x Series Display
- Conformal Coated
- NEMA 4X Outdoor Rated (3C3 model)

**Performance Specifications**

Model	SP-5B90 eXtreme Box		
Part Numbers	PFXSP5B90	PFXSP5B90F0H	
For use in Harsh and Corrosive Environments (3C3)	No	Yes	
Application Memory	On board Flash (1 GB)		
Backup Memory	NVRAM 512 KB *1		
Interfaces	Serial	COM1	RS-232C / 422 / 485, Data Length: 7 or 8 bits, Stop Bit: 1 or 2 bits, Parity: None, Even or Odd, Data Transmission Speed: 2,400 (1,200) to 115,200 bps, Connector: D-Sub 9 pin (plug)
		COM2	RS-232C / 422 / 485, Data Length: 7 or 8 bits, Stop Bit: 1 or 2 bits, Parity: None, Even or Odd, Data Transmission Speed: 2,400 (1,200) to 115,200 bps, Connector: D-Sub 9 pin (plug)
	Ethernet	Standard: IEEE802.3i/IEEE802.3u/IEEE802.3ab, 10BASE-T/100BASE-TX Connector: Modular jack (RJ-45) x 2	
	USB	Type A (V2.0) x2, Mini B (V2.0) x1	
	SD Card	SD Card slot (System) x 1 SD Card slot (Storage) x 1	
	Ethernet	IEEE802.3i/IEEE802.3u/IEEE802.3ab, 10BASE-T/ 100BASE-TX/ 1000BASE-T*2	
	Expansion unit	Fieldbus Unit x 1	
	Sound output	Speaker Output: 300mW (Rated Load: 8Ω, Frequency: 1kHz) (Software Switch), LINE Output: Rated load: 10kΩ or more (Software Switch), Connector: 2-piece terminal block (AUX) x 1	
	AUX Output Interface	Alarm output/Buzzer output, Rated voltage 24Vdc, Rated current, 50 mA, Connector 2-piece terminal block (AUX) x1	

\*1 Amount of memory you can use depends on your screen editing software. For information refer to the manual of your screen editing software.  
\*2 For 1000BASE-T communication, use twisted pair Ethernet cables with a rating of category 5e or higher.

**General Specifications**

Model	SP-5B90 Box
Part Numbers	PFXSP5B90, PFXSP5B90F0H
Rated Input Voltage	12 Vdc (Supply from Display Module)
Power Consumption	20 W Max (primary power supply including power loss)
Cooling Method	Natural air circulation
Weight	0.9kg[1.98lb] or less
External Dimensions	W188 x H131 x D45mm [W7.4 x H5.16 x D1.77 in.]
Warranty	Two (2) years

**Note:** Box Module environmental specifications follow those of the connected Display Module.

**Model Number Configuration**

**Display Module**

PFXSP5 \* \* \* \* \*

(1) (2) (3) (4) (5)

(1) Size	(2) Wireless LAN	(3) Resolution	(4) Touch Panel	(5) Power Supply
7 15"	90 eXtreme	W Wide TFT	A Analog	D DC
6 12"				
4 7"				

×

**Box Module**

PFXSP5 B \* \*

(6) (7)

(6) Module Type	(7) Class
B Box	90 eXtreme

**External Dimensions**

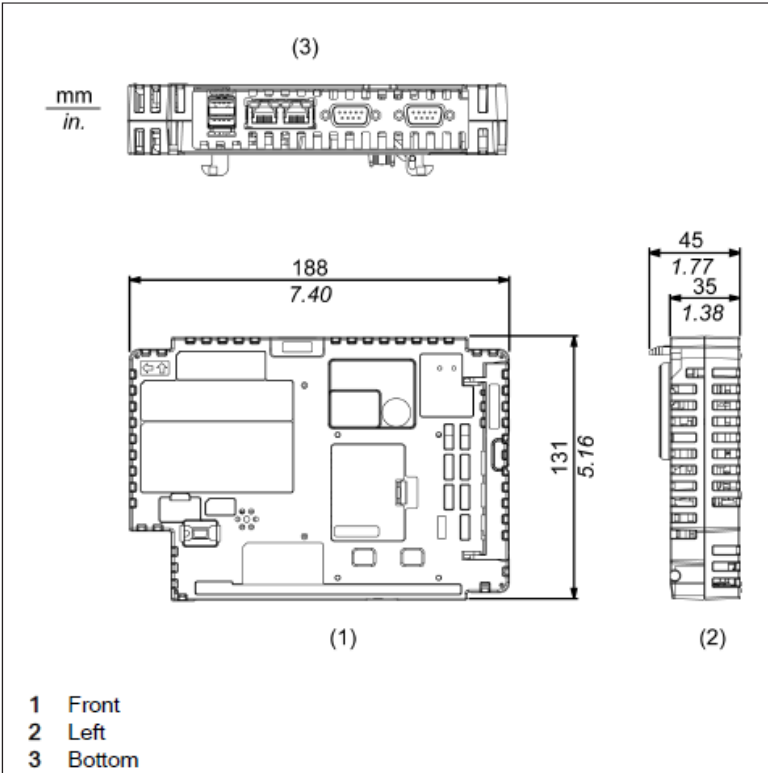

**Easy Maintenance and Modularity**

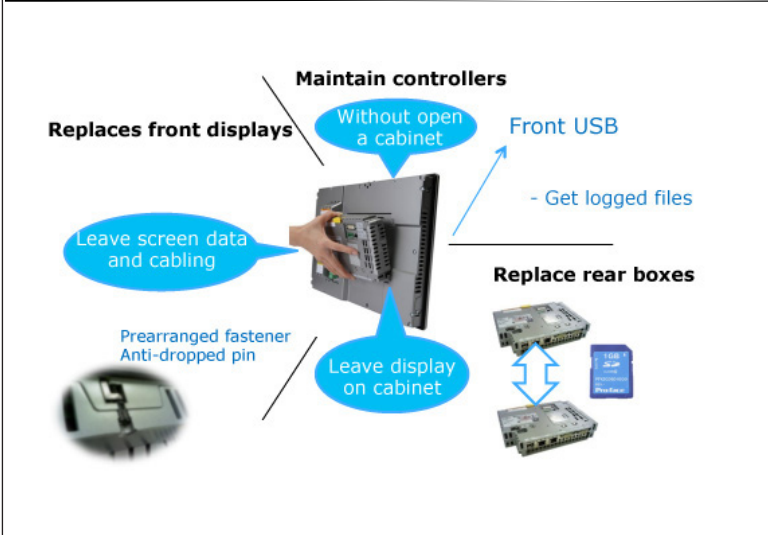

**Ordering Information**

Model Number	Description
PFXSP5B90	SP5000X Series eXtreme Box Outdoor use, Rugged, Coated, Ethernet I/F x 2, COM I/F x 2, USB A I/F x 2, USB mini-B I/F, SD Card I/F x 2, AUX I/F, Expansion Unit I/F
PFXSP5B90F0H	SP5000X Series eXtreme Box Outdoor use, plus harsh and corrosive environments (3C3) Rugged, Coated, Ethernet I/F x 2, COM I/F x 2, USB A I/F x 2, USB mini-B I/F, SD Card I/F x 2, AUX I/F, Expansion Unit I/F..

**Options**

Part Number	Description
PFXZCSD1GC61	SD Memory Card (1 GB, SLC, Class 6)
PFXZCHBMFBS1	SP5000X Series, Bracket for fixing Box module to Display module(SP-5490WA) (1 piece)
PFXZCHBMFBL1	SP5000X Series, Bracket for fixing Box module to Display module (1 piece)
PFXZCHFUB1	SP5000 Series/SP5000X Series, Bracket for fixing Fieldbus unit to Box module (1 piece)
PFXZCBCLUSA1	Clamp to prevent disconnection of USB cable (USB Type A, 1 port, 5 clamps/set)
PFXZCSD1GC61	SD memory card (1 GB, SLC) for System Card

**EXTREME Solutions**



**Oil & Gas**



**Water/Waste Water**



**Pumping Station**



**Transportation**

**Pro-face America**  
 Phone: 734.477.0600  
 www.profaceamerica.com

**Customer Service Hotline: 800.289.9266**

For more information

**ACCESS** www.profaceamerica.com

