



Power Outage Safeguards – Protecting Data Integrity

One of the reason for sudden damage to important data in PC is power outage. There is 3 solution to prevent damage for PS6000.

| Solution | | | | |
|---------------------------|---|----------------------|--------------------|-------------|
| | Behavior | Additional Equipment | Protect Area | Reliability |
| UPS | Continue to send electricity by external device | UPS | System & Data Area | High |
| RAID | Always taking backup data to storage | Storage | Data Area | Mid |
| UWF (Write Filter) | Prevent writing to the system area to avoid crash | - | System Area | Mid |

Connectivity tested UPS

Below UPS can be used with PS6000

| Model | Effect | Use case | Capacity | Reliability |
|---|--|------------------|----------|-------------|
| Schneider Electric : SMT500J - APC Smart - UPS500 | Supply electricity for long time Back-up process can be run | Long outage | Long | High |
| Schneider Electric : BVS240XDPDR - Easy UPS | | | | |
| Bicker : UPSI-2406DP2 | Safely shutdown | Momentary outage | Short | Low |

How to Video

Easy to learn how to set up the function by video with actual operation!

RAID

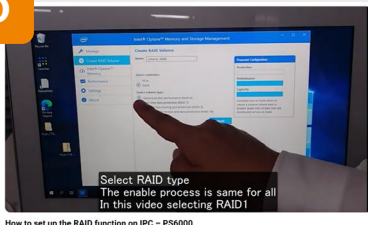

How to set up the RAID function on IPC - PS6000

<https://www.youtube.com/watch?v=9zWiCDP8DOQ!>

UWF

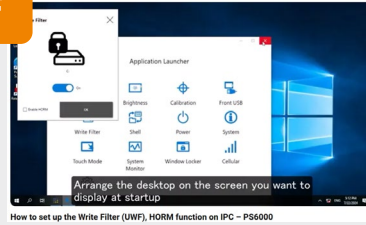

How to set up the Write Filter (UWF), HORM function on IPC - PS6000

<https://www.youtube.com/watch?v=HlxDRPjuse4>

UPS save your systems and lines

IPC systems requires the uninterruptible power supply of these components in case of a power failure, flicker and voltage drop.

UPS systems support with their reliable and long-lasting energy storages

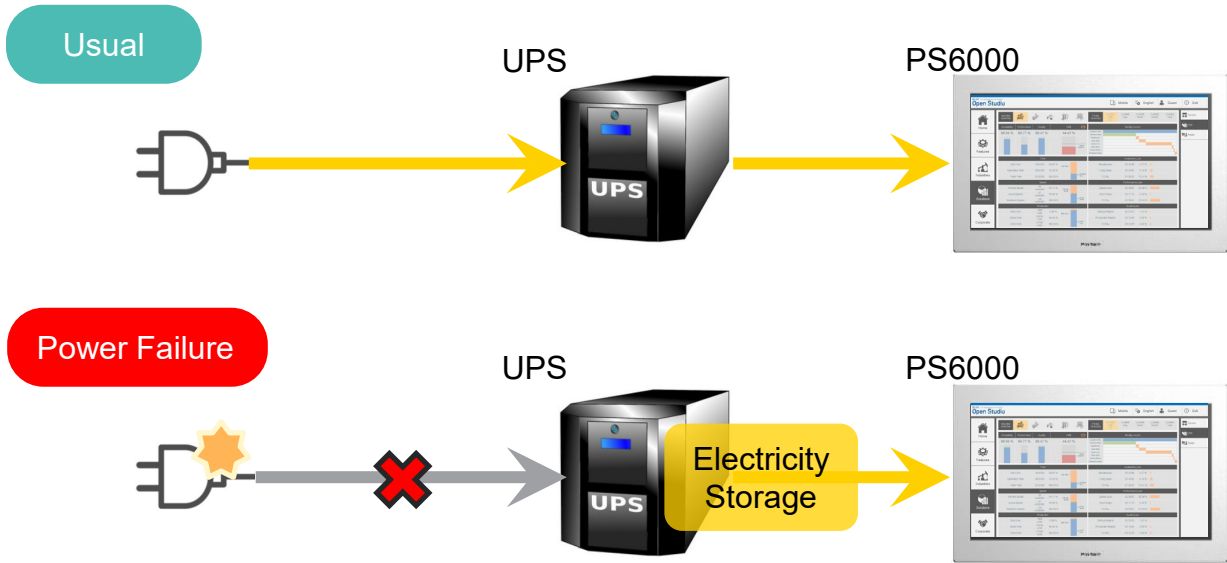

- Easily Connected by USB
- Able to shutdown the IPC without going through normal PC shutdown procedures
- Select models in your case of use

UPS Use Case

- Factory Line

Single production line stoppage can reduce overall production efficiency. Also, sudden stop of machine could damage the equipment and material, which take a lot of time to recover.

UPS safety shutdown function prevent for these risk.

- Data Collection

Sudden Power cut could damage the data or fail before data are saved. By providing the electricity from UPS, damage can be prevented and back up could run.

proface.com



[Go to PS6000 web](#)